

- NOTES:
 1. 5/8" ϕ MOUNTING HARDWARE IS RECOMMENDED FOR 8X8 AND 12X12 BASEPLATE MODELS. L-BOLT-625, STUD-ANCHOR-625.
 2. MATERIAL OF CONSTRUCTION IS 304 SS BRUSHED #4 FINISH.

UNLESS OTHERWISE SPECIFIED: DIMENSIONS ARE IN INCHES TOLERANCES: FRACTIONAL $\pm 1/32$ ANGULAR: $\pm 2^\circ$ TWO PLACE DECIMAL ± 0.010 THREE PLACE DECIMAL ± 0.005	NAME	DATE	TITLE:	REV 0
	DRAWN		INSTALLATION	
INTERPRET GEOMETRIC TOLERANCING PER: ASME Y14.5 -2009			Thursday, December 12, 2019 3:42:24 PM	
			WEIGHT:	NO SCALE
				SHEET 1 OF 7

ITEM NO.	PART NUMBER	DESCRIPTION	QTY.
6	124TOW-PRO-001-304 BODY	304 SS BODY WELDMENT	1
7	PLTACC-1254	ACCESS PANEL WELDMENT	1
8	---	8-32 x .5 PAN HEAD SCREW	12

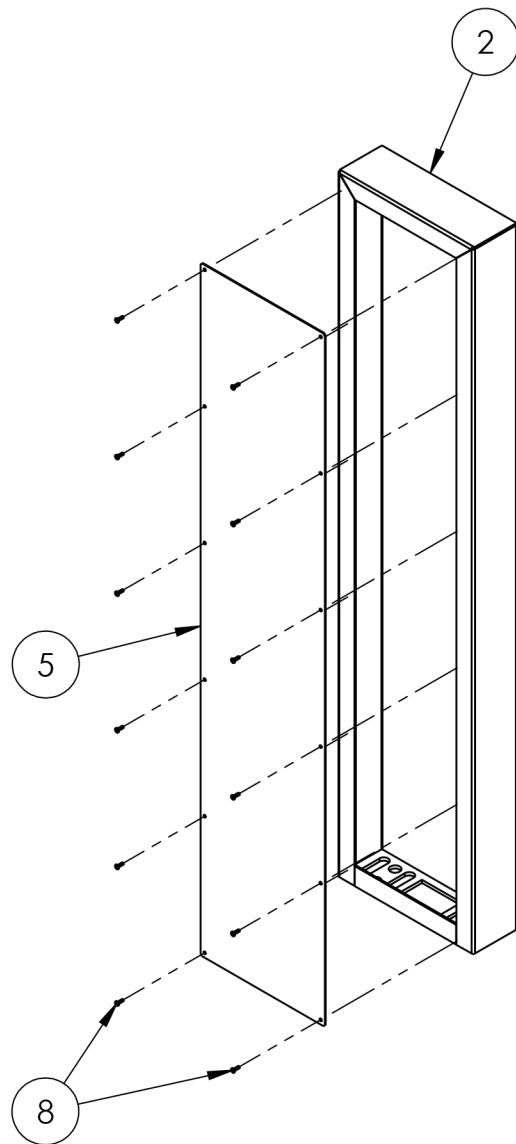

NOTES:

1. SEE STANDARD PREPARATION AND COATING INSTRUCTIONS FOR COATING PROCEDURE AND COLOR.
2. SEE STANDARD PACKAGING INSTRUCTIONS FOR PACKAGING PROCEDURE.

UNLESS OTHERWISE SPECIFIED:

DIMENSIONS ARE IN INCHES
TOLERANCES:
FRACTIONAL $\pm 1/32$
ANGULAR: $\pm 2^\circ$
TWO PLACE DECIMAL ± 0.010
THREE PLACE DECIMAL ± 0.005

INTERPRET GEOMETRIC
TOLERANCING PER:
ASME Y14.5 -2009

NAME	DATE
DRAWN	

TITLE:

ASSEMBLY

Thursday, December
12, 2019 3:42:24 PM

WEIGHT: